

Parts Manual for

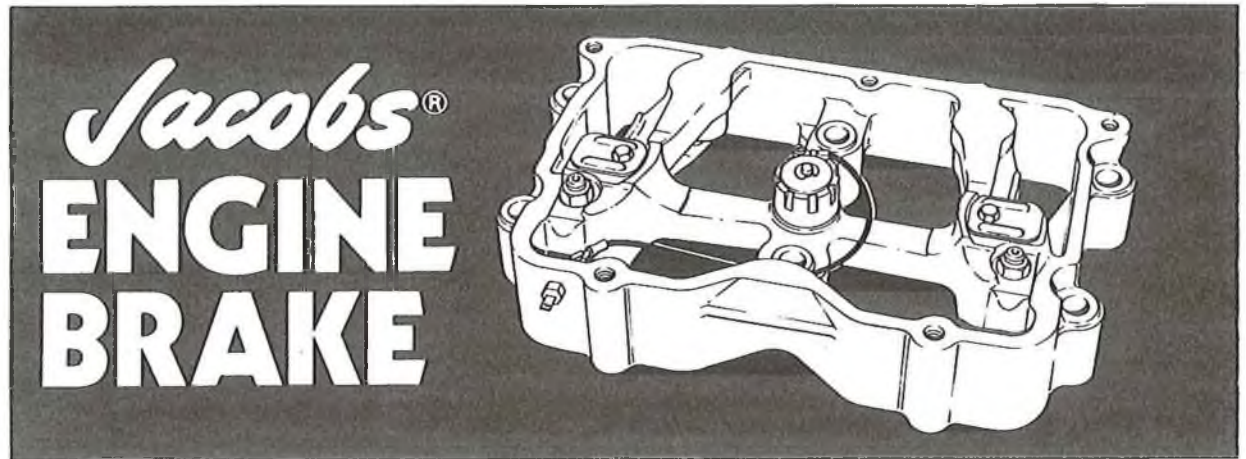

Models

400H, 400, 30E, 44B & 25B

BDC

n



The Jacobs Manufacturing Company
Vehicle Equipment Division

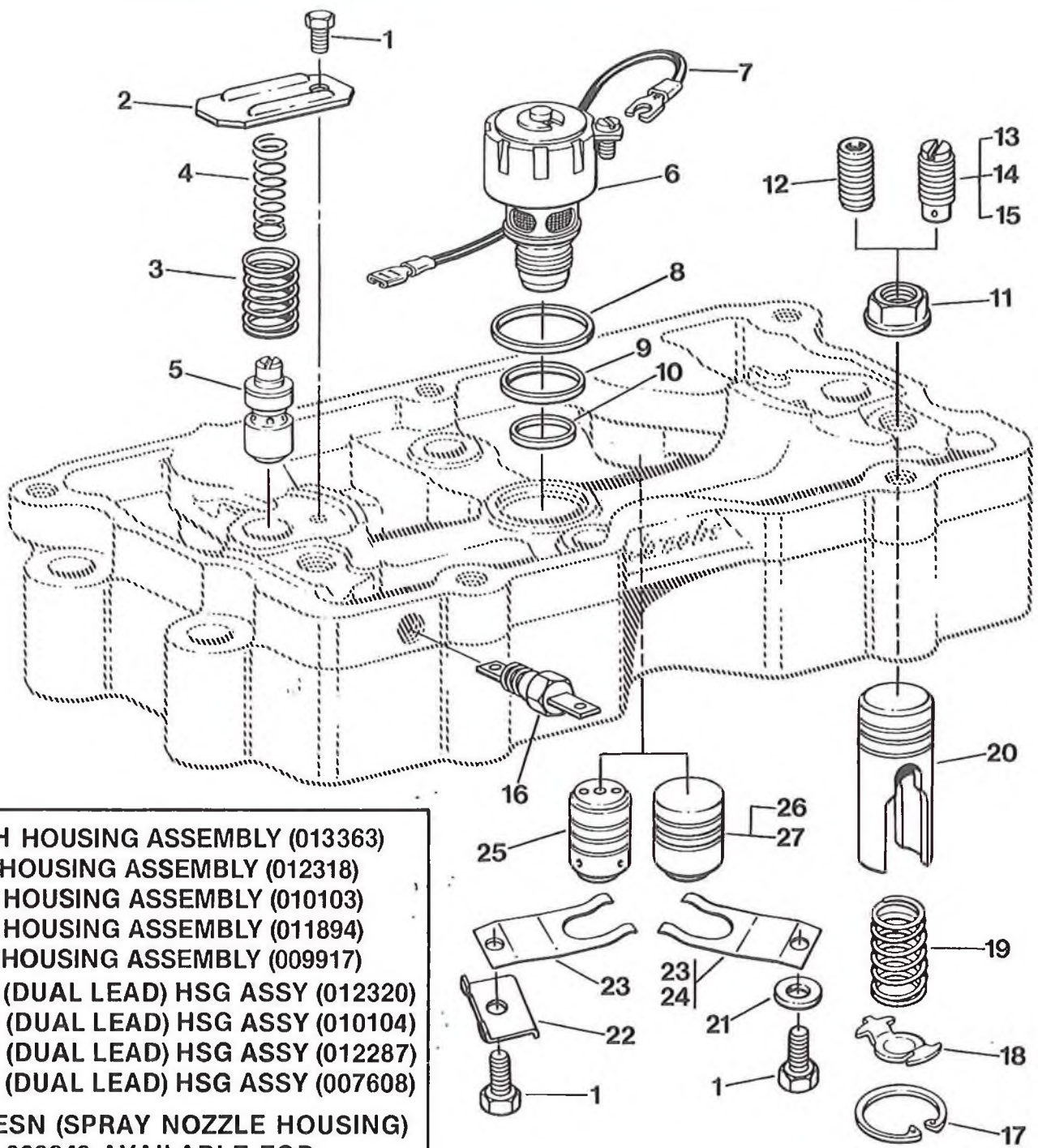

MODEL 400H HOUSING ASSEMBLY (013363)
MODEL 400 HOUSING ASSEMBLY (012318)
MODEL 44B HOUSING ASSEMBLY (010103)
MODEL 25B HOUSING ASSEMBLY (011894)
MODEL 30E HOUSING ASSEMBLY (009917)
MODEL 400 (DUAL LEAD) HSG ASSY (012320)
MODEL 44B (DUAL LEAD) HSG ASSY (010104)
MODEL 25B (DUAL LEAD) HSG ASSY (012287)
MODEL 30E (DUAL LEAD) HSG ASSY (007608)
MODEL 30ESN (SPRAY NOZZLE HOUSING)
P/N 009349 AVAILABLE FOR
REPLACEMENT PARTS ONLY.

• These Parts Must Be Used As Sets. 25B,30E Only

| Illus. No. | Part No. | Part Name | Qty/Assy | | | | |
|------------|----------|----------------------------|----------|-----|-----|-----|-----|
| | | | 400H | 400 | 44B | 25B | 30E |
| 1 | 001492 | Capscrew | 4 | 4 | 4 | 4 | 4 |
| 2 | 004136 | Cover — Control Valve | 2 | 2 | 2 | 2 | 2 |
| 3 | 001519 | Spring — Outer | 2 | 2 | 2 | 2 | 2 |
| 4 | 007500 | Spring — Inner | 2 | 2 | 2 | 2 | 2 |
| 5 | 007505 | Spool Assy — Control Valve | 2 | 2 | 2 | 2 | 2 |
| 6 | 004205 | Valve Assembly — Solenoid | 1 | 1 | 1 | 1 | 1 |
| *6 | 003433 | Valve Assy-Solenoid | 1 | 1 | 1 | 1 | 1 |
| **7 | 002390 | Harness — Solenoid | 1 | 1 | 1 | 1 | 1 |
| 8 | 001081 | Seal Ring — Upper | 1 | 1 | 1 | 1 | 1 |
| 9 | 001082 | Seal Ring — Center | 1 | 1 | 1 | 1 | 1 |
| 10 | 001083 | Seal Ring — Lower | 1 | 1 | 1 | 1 | 1 |
| 11 | 009353 | Nut — Hex Jam | 2 | 2 | 2 | 2 | 2 |
| 12 | 009916 | Set Screw | | | | 2 | 2 |
| 13 | 010249 | Auto-Lash Assembly | | | 2 | | |

| Illus. No. | Part No. | Part Name | Qty/Assy | | | | |
|------------|----------|---------------------------------|----------|-----|-----|-----|-----|
| | | | 400H | 400 | 44B | 25B | 30E |
| 14 | 009329 | Auto-Lash Assembly | | | 2 | | |
| 15 | 013197 | Auto-Lash Assembly | 2 | | | | |
| *16 | 002299 | Terminal Assembly | 1* | 1* | 1* | 1* | 1* |
| •17 | 001023 | Ring — Retainer | 2 | 2 | 2 | 2 | 2 |
| •18 | 008895 | Retainer — Spring | 2 | 2 | 2 | 2 | 2 |
| 19 | 001022 | Spring — Slave Piston | 2 | 2 | 2 | 2 | 2 |
| **20 | 007623 | Piston — Slave | 2 | 2 | 2 | 2 | 2 |
| 21 | 001030 | Washer — Plain | 2 | 2 | | 2 | 2 |
| 22 | 010819 | Retainer — Spring | | | 2 | | |
| 23 | 007447 | Spring — Flat | 2 | 2 | 2 | | 2 |
| 24 | 011841 | Spring — Flat | | | | 2 | |
| 25 | 007942 | Master Piston—Pressure Relief | | | 2 | | |
| 26 | 004089 | Master Piston—(3/8" Dia. Solid) | 2 | 2 | | | 2 |
| 27 | 001017 | Master Piston—(1/2" Dia. Solid) | | | | 2 | |

*For Dual Lead Appl. **Not Used With Dual Lead Appl.

BDC for engine manuals and specs
<https://barringtondieselclub.co.za/>

*Quantity is 2/Assy with Dual Lead Applications

**•Short Slave Piston PN007696

3776 SWITCH ASSEMBLY

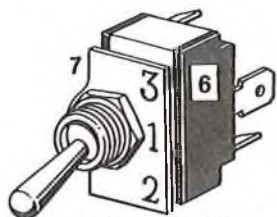
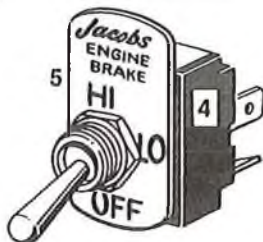
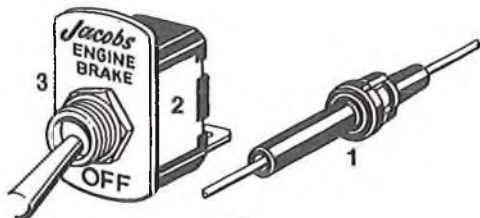

2970 TOGGLE SWITCH GROUP

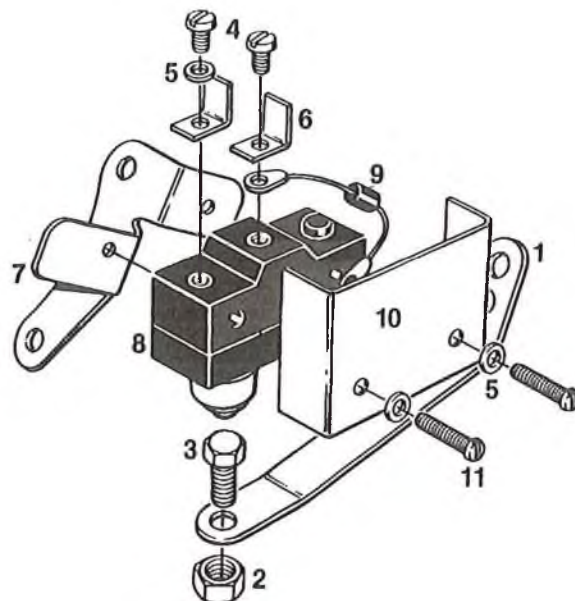

1495 CLUTCH SWITCH ASSEMBLY

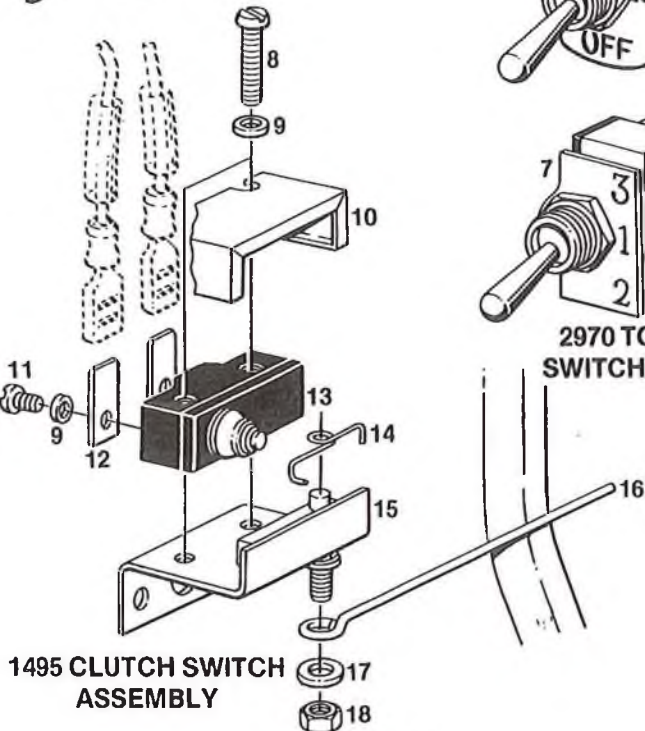

002102, 002103, 010128, 010131 & 012665 ENGINE CONTROL GROUPS

| Illus. No. | Part No. | Part Name | Qty/Group | | | | |
|------------|----------|-----------------|------------------|------------------|-----------------------|------------------|------------------|
| | | | 002102 Pos. Gnd. | 002103 Neg. Gnd. | 010128 Dual Lead Pos. | 010131 Neg. Gnd. | 012665 Neg. Gnd. |
| 1 | 001179 | Arm — Actuator | 1 | 1 | 1 | 1 | 1 |
| 2 | 001181 | Nut — Hex | 1 | 1 | 1 | 1 | 1 |
| 3 | 001182 | Screw — Hex | 1 | 1 | 1 | 1 | 1 |
| | 001219 | Switch Assy | | 1 | | 1 | |
| | 002112 | Switch Assy | 1 | | 1 | | |
| | 007671 | Switch Assy | | | | | 1 |
| 4 | 001558 | • Screw | 2 | 2 | 2 | 2 | 2 |
| 5 | 001559 | • Lock Washer | 3 | 3 | 3 | 3 | 3 |
| 6 | 001512 | • Tab — Q-Disc. | 2 | 2 | 2 | 2 | 2 |
| 7 | 001178 | • Bracket | 1 | 1 | 1 | 1 | |
| 7 | 006796 | • Bracket | | | | | 1 |
| 8 | 001218 | • Switch | 1 | 1 | 1 | 1 | 1 |
| 9 | 001534 | • Diode | 1 | 1 | 1 | 1 | 1 |
| 10 | 001180 | • Switch Cover | 1 | 1 | 1 | 1 | 1 |
| 11 | 001244 | • Screw | 2 | 2 | 2 | 2 | 2 |
| N.I. | 003708 | Shrink Tube | 3 | 3 | 3 | 3 | 3 |
| N.I. | 002014 | Receptacle | 3 | 3 | 3 | 3 | 3 |
| N.I. | 003881 | Harness | 3 | 3 | 3 | 3 | 3 |
| N.I. | 001955 | Harness | | | 1 | 1 | |
| N.I. | 003778 | Loom | | | | | 1 |

003965, 010132, CAB CONTROL GROUPS

| Illus. No. | Part No. | Part Name | Qty/Group | |
|------------|----------|--------------------------------|------------|-----------------|
| | | | All Models | *Dual Lead Only |
| 1 | 001300 | Harness — Ign. to Dash | 1 | — |
| 2 | 001304 | Switch — Toggle Dash | 1 | — |
| 3 | 001305 | Plate | 1 | — |
| | 003776 | Switch Assembly — Dash | | 1 |
| 4 | 003586 | • Switch — Toggle (3-Position) | — | 1 |
| 5 | 003777 | • Plate — Dash Switch | — | 1 |
| | 002970 | Switch Group — Toggle | 1 | — |
| 6 | 002957 | • Switch — Toggle (3-Position) | 1 | — |
| 7 | 002959 | • Plate — Dash Switch | 1 | — |
| | 001495 | Switch Assembly — Clutch | 1 | 1 |
| 8 | 001244 | • Screw — Tapping | 2 | 2 |
| 9 | 001559 | • Washer — Lock | 4 | 4 |
| 10 | 001506 | • Cover — Switch | 1 | 1 |
| 11 | 001558 | • Screw — Binder Head | 2 | 2 |
| 12 | 001040 | • Terminal | 2 | 2 |
| 13 | 001218 | • Switch | 1 | 1 |
| 14 | 001497 | • Spring — Actuating Lever | 1 | 1 |
| 15 | 002198 | • Bracket and Lever Assy | 1 | 1 |
| 16 | 002183 | • Rod — Switch Actuating | 1 | 1 |
| 17 | 002190 | • Washer — Flat | 1 | 1 |
| 18 | 002186 | • Nut — Hex | 1 | 1 |
| N.I. | 003278 | Receptacle | 6 | 5 |
| N.I. | 003707 | Tube — Shrink | 6 | 6 |
| N.I. | 003781 | Wire — Harness | 1 | 1 |
| N.I. | 003780 | Harness — Ign. to Clutch | — | 1 |
| N.I. | 003807 | Terminal — Spade | — | 1 |
| N.I. | 003964 | Wiring Diagram | 1 | — |
| N.I. | 009972 | Wiring Diagram | — | 1 |
| N.I. | 006833 | Tie — Cable | 12 | 12 |

MISCELLANEOUS ACCESSORIES

| Illus. No. | Part No. | Part Name | Qty/Eng. |
|------------|----------|---|----------|
| 1 | 001153 | Gage—Exhaust Rocker Lever Grinding Fixture | 1 |
| 2 | 001593 | Air Intake Connection for Int'l. DC0405 Truck | 1 |

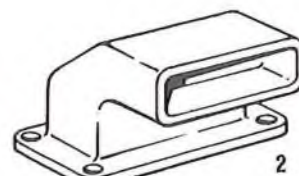
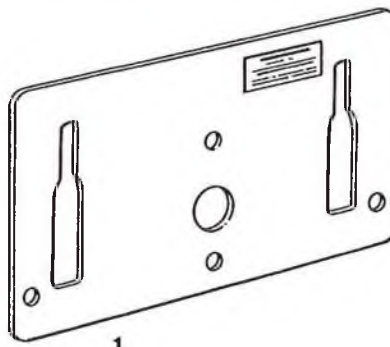

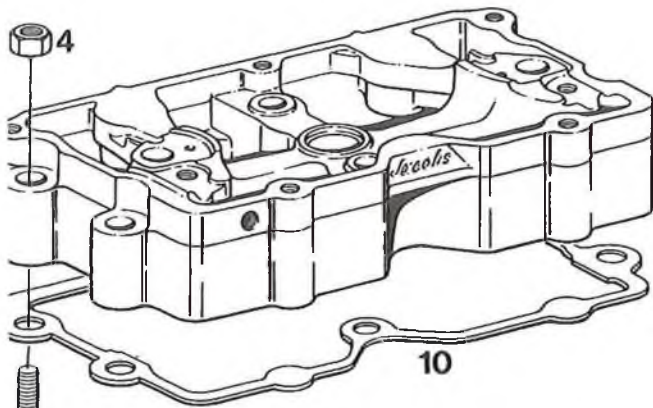

STUD AND SPACER GROUPS

| Illus. No. | Part Number | Part Name | Qty./6 Cyl. Eng. | |
|------------|-------------|--|------------------|--------|
| | | | 012368 | 012372 |
| 4 | 001094 | Nut—Hex | 18 | 18 |
| 5 | 001234 | Spacer (Use w/All Lift. Eyes) | 4 | 10 |
| 6 | 013012 | 7 1/8" (181mm) Long Stud | 12 | 8 |
| 7 | 001232 | 8 1/8" (206mm) long Stud (Use with Dual Head Lifting Eyes) | 4 | 8 |
| 8 | 002514 | Washer—Bearing | 18 | 18 |
| *9 | 002856 | 8 3/8" (219.07mm) Stud | 2 | 2 |

*Use with Compression Release Fan Support Bracket and Single Head Lifting Eye.

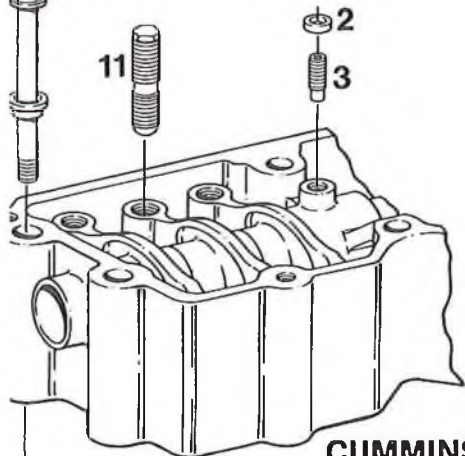

ENGINE CONVERSION PARTS

| Illus. No. | Part No. | Part Name | Qty/6 |
|------------|----------|-----------------------------------|-----------|
| | | | Cyl. Eng. |
| 10 | 013294 | Gasket—Rocker Hsg. to Brake Hsg. | 3 |
| *11 | 001015 | Screw Inj. Adj. 5/8"-18 | 6 |
| *11 | 003678 | Screw Inj. Adj. 1/2"-20 with Slot | 6 |

* Select one to match engine parts

CUMMINS ROCKER HOUSING

SINGLE CUMMINS CYLINDER HEAD

SERVICE TOOLS AND PARTS

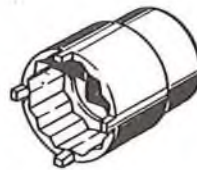

PN 011494
SOLENOID
WRENCH

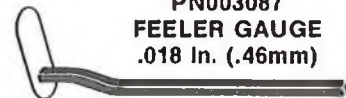

PN003087
FEELER GAUGE
.018 In. (.46mm)



PN 001283 SOLENOID
SCREEN RETAINER



PN 001282
SOLENOID
SCREEN

CONTROL SYSTEM OPTIONS

!663 HOUSING ATTACHING PARTS GROUP

One Group Per Brake Housing

| Illus. No. | Part No. | Part Name | Qty/Group |
|------------|----------|----------------------------|-----------|
| 1 | 011573 | Cross Head — Exhaust Valve | 2 |
| 2 | 010180 | Seal Ring | 1 |
| 3 | 002969 | Screw — Oil Supply | 1 |

PN 012260
FOOT SWITCH

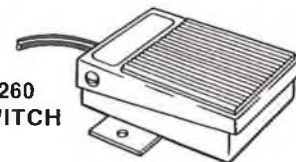

PN 010489 SWITCH KIT
LOW SPEED SHUTOFF

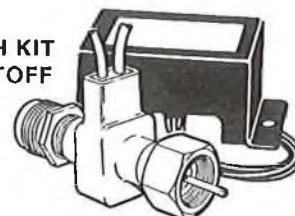

SIDE MOUNT

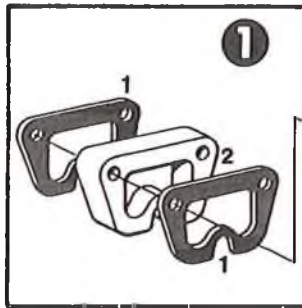
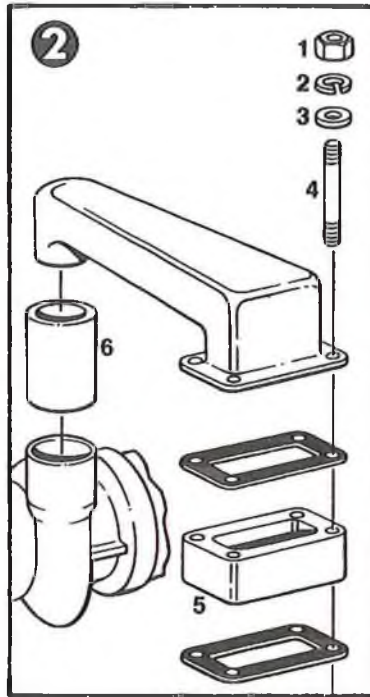

2359 SPACER KIT – OFFSET INT. MANIFOLD (For Use w/Cummins 177273 Air Int. Manifold)

| Illus. No. | Part No. | Part Name | Qty/Kit |
|------------|----------|--|---------|
| 1 | 002357 | Gasket—Manifold to Head | 6 |
| *2 | 002354 | Spacer—Intake Manifold 1/2" Thick | 3 |
| 3 | 002355 | Cap Screw—Hex Head 3/8"-16x1 1/2" Long | 6 |
| N.I. | 003624 | Cap Screw—Hex Head 3/8"-16x2" Long | 3 |

* If Air Compressor Governor interference occurs, use optional 5/8" thick spacer Part No. 2806

SPACER GROUP – AIR INTAKE MANIFOLD CONNECTION PART NO. 1271

(For Use on Cummins Side Mnt Turbochgrs)

| Illus. No. | Part No. | Part Name | Qty/Group |
|------------|----------|---|-----------|
| 1 | 001276 | Nut—Hex (Air Intake Manifold Conn. Stud) | 4 |
| 2 | 001275 | Washer—Lock (Air Inlet Manifold Conn. Stud) | 4 |
| 3 | 001274 | Washer Plain (Air Inlet Manifold Conn. Stud) | 4 |
| 4 | 001273 | Stud—(Air Intake Manifold Connection) | 4 |
| *5 | 001226 | Spacer—2 3/8" Thick (Air Inlet Manifold Conn.) | 1 |
| **6 | 001229 | Air Outlet Conn. 3 3/8" I.D. (Used on T50, VT-50 or T-590 Turbocharger) | 1 |
| **6 | 001255 | Air Outlet Conn. 3" I.D. Used on T-506 Turbocharger) | 1 |

* Available Optional Spacers: 1 5/8" thick Part No. 1065, 1" thick Part No. 1714 and 1/2" thick Part No. 2805.

NOTE: If there is sufficient Engine Brake installation clearance

TOP MOUNT

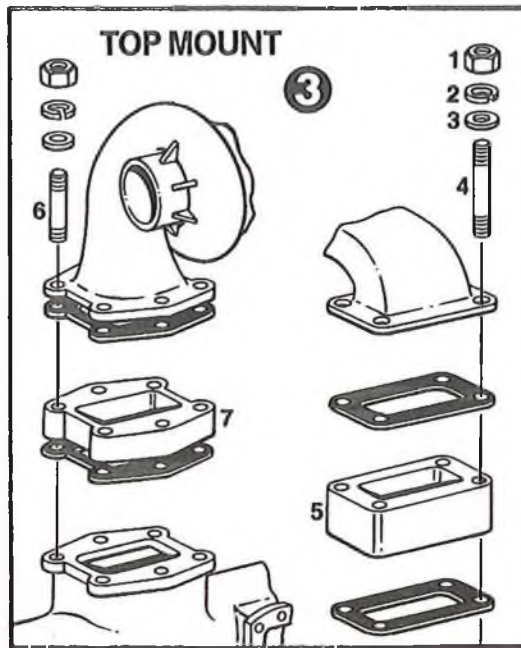

MANIFOLD SPACER GROUPS

SPACER GROUP – AIR INTAKE MANIFOLD CONNECTION PART NO. 1271

(For Use on Cummins Top Mnt. Turbochgrs.)

| Illus. No. | Part No. | Part Name | Qty/Group |
|------------|----------|---|-----------|
| 1 | 001276 | Nut—Hex (Air Inlet Manifold Conn. Stud) | 4 |
| 2 | 001275 | Washer—Lock (Air Inlet Manifold Conn. Stud) | 4 |
| 3 | 001274 | Washer—Plain (Air Inlet Manifold Conn. Stud) | 4 |
| 4 | 001273 | Stud (Air Intake Manifold Connection) | 4 |
| 5 | 001226 | Spacer—2 3/8" Thick (Air Int. Manifold Conn.) | 1 |

Select One Exh. Manifold Spacer Group to Match Turbocharger.

1170 EXHAUST MANIFOLD SPACER GROUP (For Use w/T-50 & T-590 Top Mnt. Turbochgrs.)

| Illus. No. | Part No. | Part Name | Qty/Group |
|------------|----------|---|-----------|
| 6 | 001167 | Stud (Turbocharger to Exhaust Manifold) | 6 |
| 7 | 001165 | Spacer (Turbocharger to Exhaust Manifold) | 1 |

1171 EXHAUST MANIFOLD SPACER GROUP (For Use w/T-506 Top Mount Turbocharger)

| Illus. No. | Part No. | Part Name | Qty/Group |
|------------|----------|---|-----------|
| 6 | 001167 | Stud (Turbocharger to Exhaust Manifold) | 6 |
| 7 | 001166 | Spacer (Turbocharger to Exhaust Manifold) | 1 |

2947 EXH. MANIFOLD SPACER GP. (4 HOLE) (For Use w/VT-50 Top Mount Turbocharger)

| Illus. No. | Part No. | Part Name | Qty/Group |
|------------|----------|---|-----------|
| 6 | 002899 | Stud (Turbocharger to Exhaust Manifold) | 4 |
| 7 | 002898 | Spacer (Turbocharger to Exhaust Manifold) | 1 |

COMPRESSION RELEASE BELL CRANK

(With Fan Support Bracket)

3250 CONVERSION GROUP

(FOR ENGINES WITH 7/16" -14 FAN SUPPORT BRACKET BOLTS AND 12-POINT HEAD COMPRESSION RELEASE SHAFT)

| Illus. No. | Part No. | Part Name | Qty/Group |
|------------|----------|---|-----------|
| 1 | 003252 | Cap Screw — Hex Hd. 7/16" - 14 | 2 |
| 2 | 003251 | Spacer — Fan Bracket | 2 |
| 3 | 003286 | Cap Screw — Hex Hd. 1/4" -20 | 1 |
| 4 | 001030 | Washer — Plain | 1 |
| 5 | 003285 | Support — Fan Bracket Brace | 1 |
| 6 | 003254 | Shaft — Compression Release (12-Pt. Hd.) | 1 |
| 7 | 001235 | Spacer — Compression Release, Lower Lever | 1 |
| 8 | 001061 | Roll Pin — Compression Release Lever | 1 |

COMPRESSION RELEASE BELL CRANK

(With Fan Support Bracket)

2880 CONVERSION GROUP

(FOR ENGINES WITH 1/2" -13 FAN SUPPORT BRACKET BOLTS AND 12-POINT HEAD COMPRESSION RELEASE SHAFT)

| Illus. No. | Part No. | Part Name | Qty/Group |
|------------|----------|---|-----------|
| 1 | 001237 | Cap Screw — Hex Hd. 1/2" -13 | 2 |
| 2 | 001236 | Spacer — Fan Bracket | 2 |
| 6 | 003254 | Shaft — Compression Release (12-Pt. Hd.) | 1 |
| 7 | 001235 | Spacer — Compression Release, Lower Lever | 1 |
| 8 | 001061 | Roll Pin — Compression Release Lever | 1 |

COMPRESSION RELEASE BELL CRANK CONVERSION GROUPS

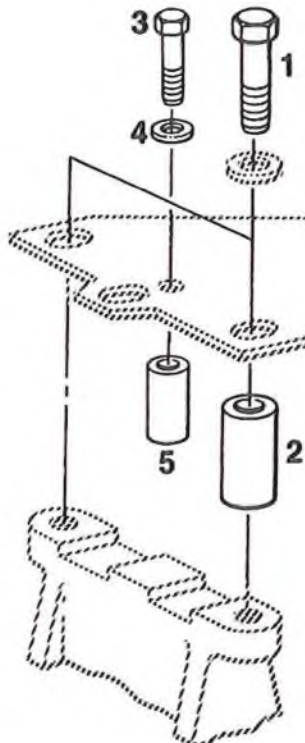

COMPRESSION RELEASE BELL CRANK

(With Fan Support Bracket)

2878 CONVERSION GROUP

(FOR ENGINES WITH 1/2" -13 FAN SUPPORT BRACKET BOLTS AND PLAIN HEAD COMPRESSION RELEASE SHAFT)

| | | | |
|---|--------|---|---|
| 1 | 001237 | Cap Screw — Hex Hd. 1/2" -13 | 2 |
| 2 | 001236 | Spacer — Fan Bracket | 2 |
| 7 | 001235 | Spacer — Compression Release, Lower Lever | 1 |
| 8 | 001061 | Roll Pin — Compression Release Lever | 1 |
| 9 | 001233 | Shaft — Compression Release (Plain Head) | 1 |

5344 FAN BRACKET SPACER GROUP

| Illus. No. | Part No. | Part Name | Qty/Group |
|------------|----------|----------------------|-----------|
| 1 | 012647 | Cap Screw - Hex Head | 2 |
| 2 | 003251 | Spacer - Fan Bracket | 2 |

